

SINGLE-PLY: TPO & PVC 60-80 mil membranes

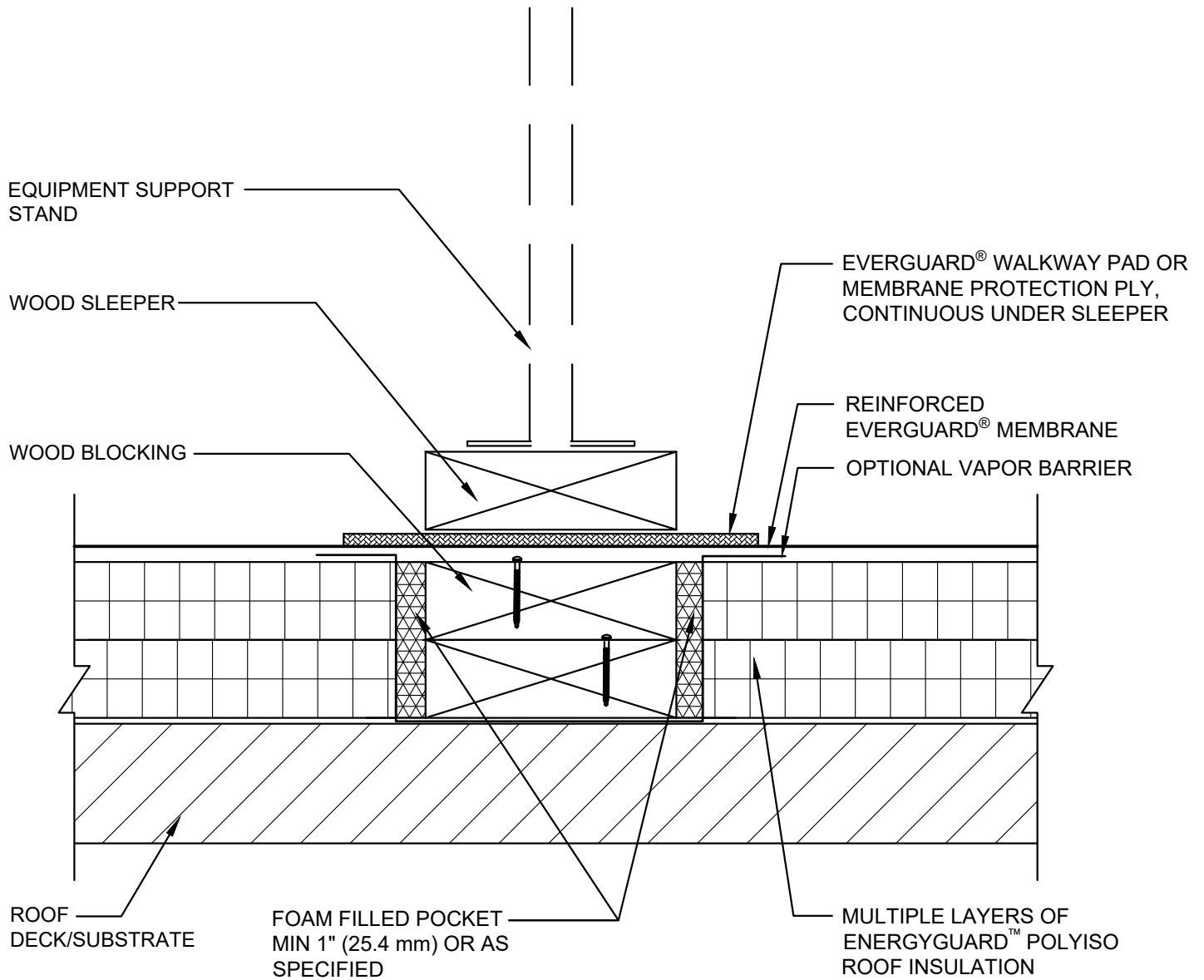

EXPOSED WOOD EQUIPMENT SUPPORT SLEEPER DETAIL

DRAWING #
511B

THIS DETAIL APPLIES TO:
ADHERED SYSTEMS
MECHANICALLY ATTACHED SYSTEMS
RHINO BOND® SYSTEMS

ISSUE / REVISION DATE
7/28/2023

SCALE
N.T.S.

LEGEND

 CLOSED CELL FOAM INSULATION