

SINGLE-PLY: TPO & PVC 60-80 mil membranes

ALTERNATE INSTALLATION  
[12" (305 mm) OR MORE OF INSULATION]

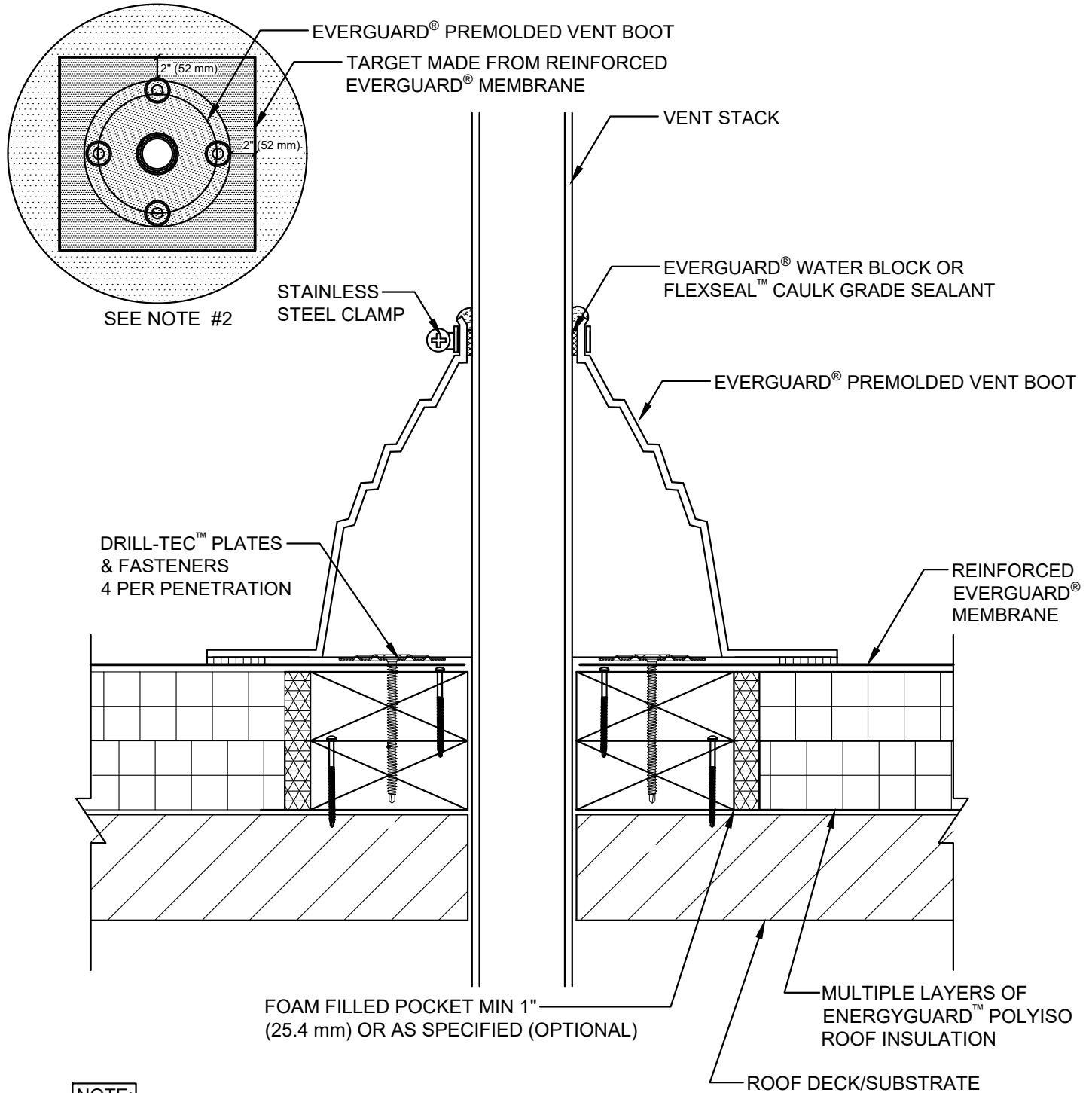

NOTE:

1. DO NOT CUT SIDE OF PREMOLDED BOOT. IT MUST BE PULLED OVER VENT PIPE.
2. IF THE PLATES AND FASTENERS INTRUDE INTO BOOT FLANGE AREA, THEN A TARGET MUST FIRST BE INSTALLED OVER PLATES AND FASTENERS BEFORE BOOT INSTALLATION.

LEGEND

- HEAT-WELDED
- FLEXSEAL™ CAULK GRADE SEALANT
- CLOSED CELL FOAM INSULATION