

SINGLE-PLY: TPO & PVC 60-80 mil membranes

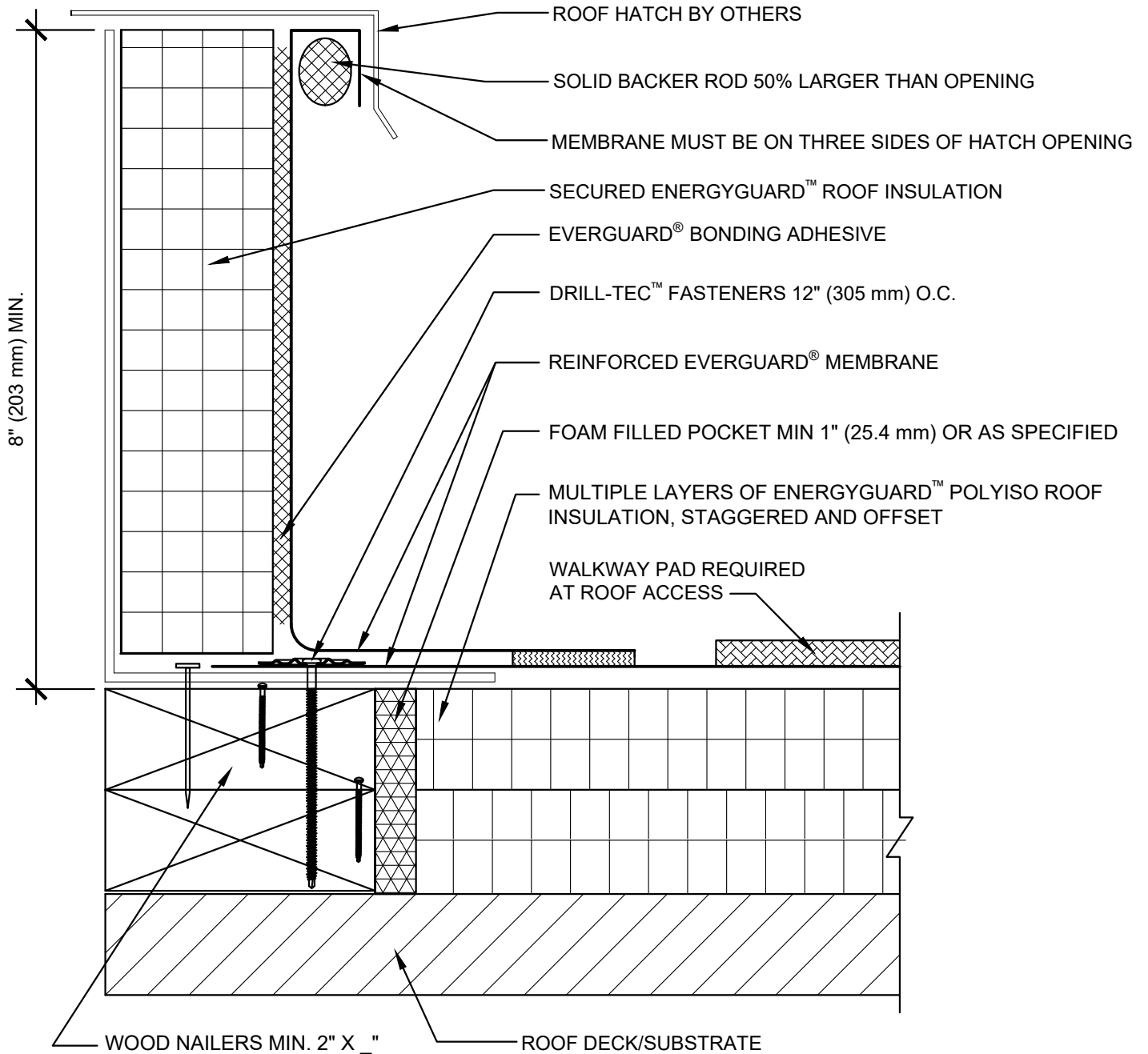

NOTE:

1. FOR STEEL ROOF DECKS: FILL STEEL DECK FLUTES WITH CLOSED CELL SPRAY FOAM INSULATION PRIOR TO THE INSTALLATION OF ABOVE DECK INSULATION A MINIMUM OF 12 INCHES (305 mm) FROM FACE OF OPENING.

| | | | | |
|------------|--|---|---|---|
| GAF | ROOF HATCH DETAIL - AMBIENT INTERIOR CONDITIONS | | | LEGEND |
| | DRAWING # 505B | THIS DETAIL APPLIES TO: ADHERED SYSTEMS MECHANICALLY ATTACHED SYSTEMS RHINOBOND® SYSTEMS | ISSUE / REVISION DATE 7/28/2023 | SCALE N.T.S. |
| | | | |  HEAT-WELDED  EVERGUARD® BONDING ADHESIVE  CLOSED CELL FOAM INSULATION |