

SINGLE-PLY: TPO 60-80 mil membranes

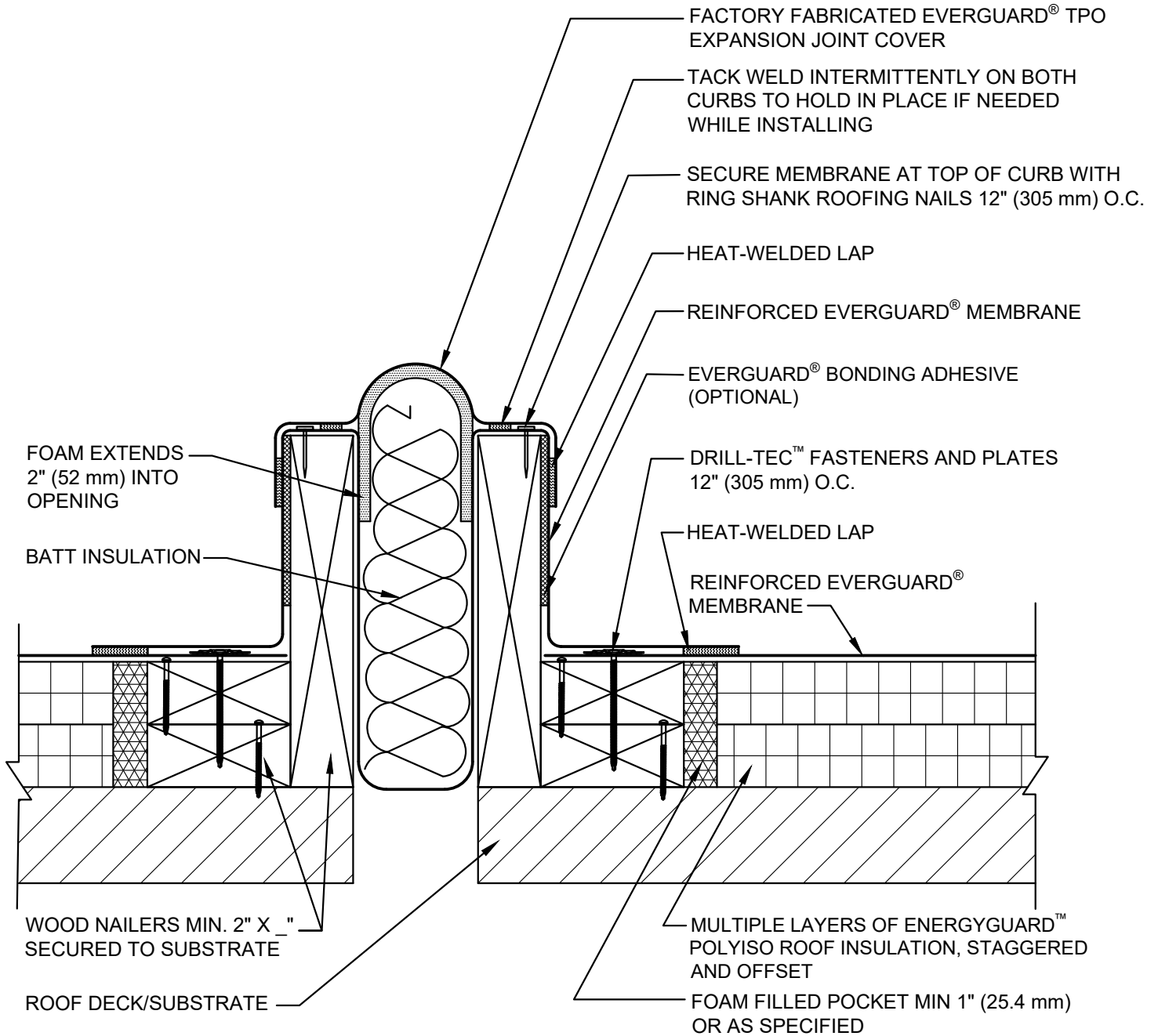

NOTE:

1. SEE EVERGUARD DETAIL 330 FOR LAP APPLICATION.
2. FOR STEEL ROOF DECKS: FILL STEEL DECK FLUTES WITH CLOSED CELL SPRAY FOAM INSULATION PRIOR TO THE INSTALLATION OF ABOVE DECK INSULATION A MINIMUM OF 12 INCHES (305 mm) FROM EDGE OF EXPANSION JOINT.

| | | | | | |
|------------|---|--|---|-----------------|---|
| GAF | FACTORY FABRICATED EXPANSION JOINT - CURB TYPE | | | LEGEND | |
| | DRAWING # 402E | THIS DETAIL APPLIES TO: ADHERED SYSTEMS MECHANICALLY ATTACHED SYSTEMS RHINO BOND® SYSTEMS | ISSUE / REVISION DATE 7/28/2023 | SCALE N.T.S. | HEAT-WELDED EVERGUARD® WATER BLOCK EVERGUARD® BONDING ADHESIVE CLOSED CELL FOAM INSULATION |