

SINGLE-PLY: TPO 60-80 mil membranes

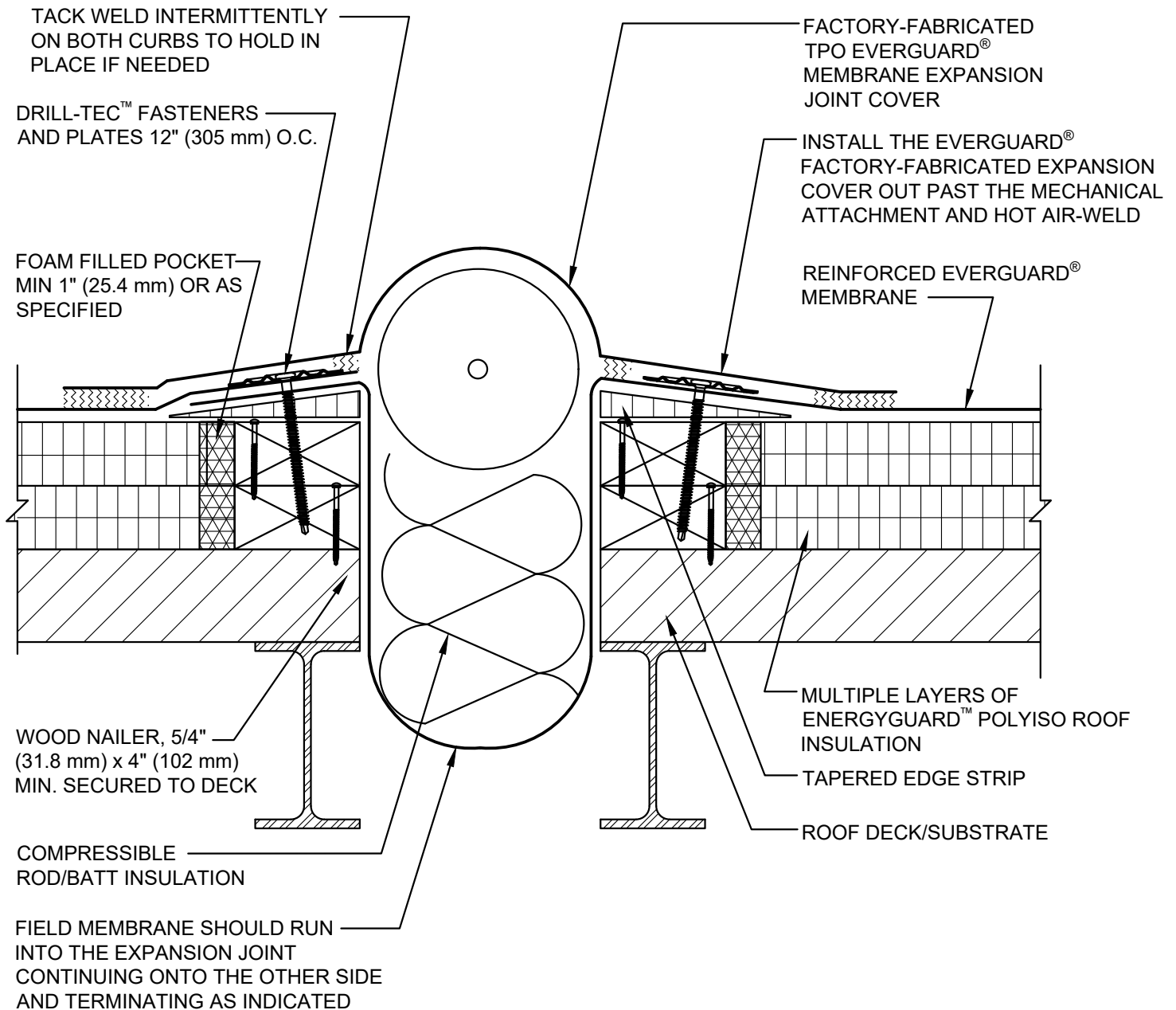

NOTE:

1. SEE EVERGUARD® DETAIL 330 FOR LAP APPLICATION.
2. FOR STEEL ROOF DECKS: FILL STEEL DECK FLUTES WITH CLOSED CELL SPRAY FOAM INSULATION PRIOR TO THE INSTALLATION OF ABOVE DECK INSULATION A MINIMUM OF 12 INCHES (305 mm) FROM EDGE OF EXPANSION JOINT.



FIELD FABRICATED EXPANSION JOINT DETAIL
- FLAT TYPE

DRAWING #
401D

THIS DETAIL APPLIES TO:
ADHERED SYSTEMS
MECHANICALLY ATTACHED SYSTEMS
RHINO-BOND® SYSTEMS

ISSUE / REVISION DATE
7/28/2023

SCALE
N.T.S.

LEGEND

- HEAT-WELDED
- CLOSED CELL FOAM INSULATION